

# Soils Map

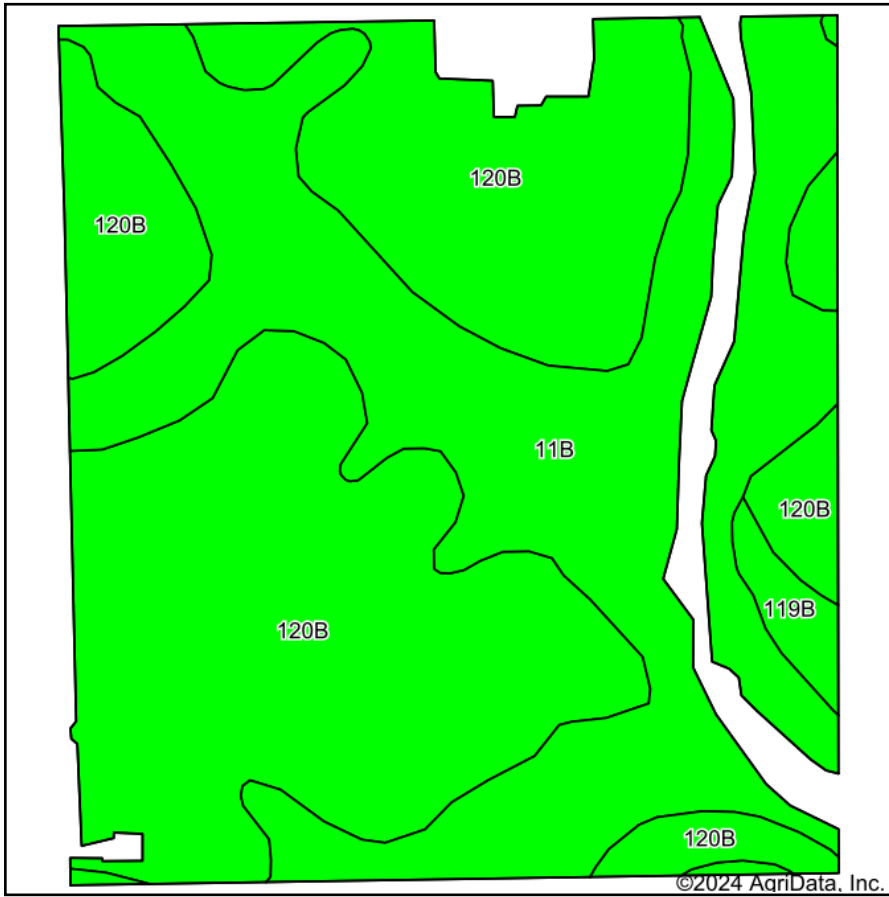

Soils data provided by USDA and NRCS.

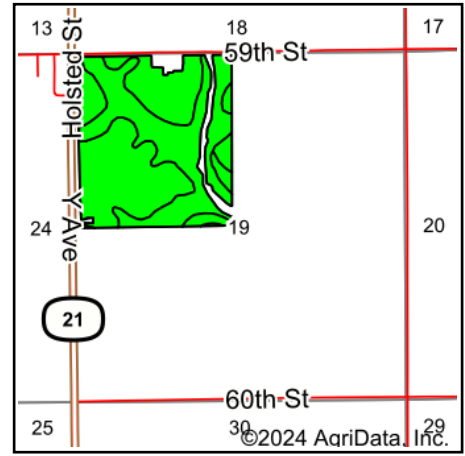

State: **Iowa**  
 County: **Benton**  
 Location: **19-85N-12W**  
 Township: **Monroe**  
 Acres: **131.04**  
 Date: **1/2/2024**



Maps Provided By:



© AgriData, Inc. 2023

www.AgriDataInc.com



Area Symbol: IA011, Soil Area Version: 26

Code	Soil Description	Acres	Percent of field	CSR2 Legend	Non-Irr Class *c	CSR2**	CSR	
120B	Tama silty clay loam, 2 to 5 percent slopes	75.29	57.5%		Ile	95	95	
11B	Colo-Ely complex, 0 to 5 percent slopes	53.50	40.8%		Ilw	86	68	
119B	Muscatine silty clay loam, 2 to 5 percent slopes	2.02	1.5%		Ile	95	95	
377C	Dinsdale silty clay loam, 5 to 9 percent slopes	0.23	0.2%		Ille	90	75	
<b>Weighted Average</b>						<b>2.00</b>	<b>91.3</b>	<b>83.9</b>

\*\*IA has updated the CSR values for each county to CSR2.

\*c: Using Capabilities Class Dominant Condition Aggregation Method

Soils data provided by USDA and NRCS.